



**1b Hatchgate Close, West Sussex, RH17 5DT**

**O.I.R.O £175,000 Share of Freehold**



## Floor Plan

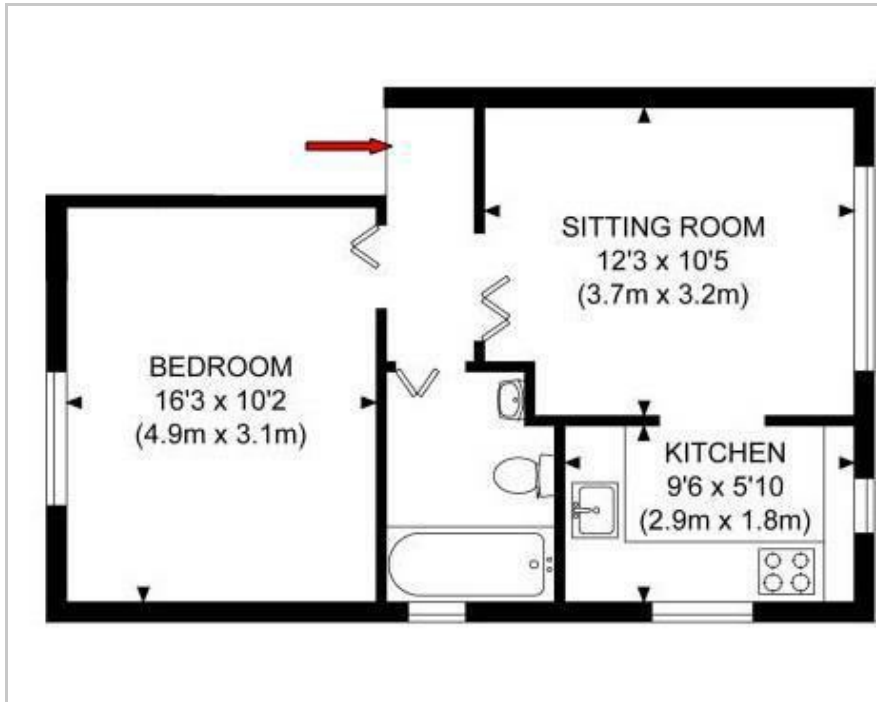

## Area Map



## Accommodation

This well proportioned flat has a good sized double bedroom, bright and spacious living room with a well fitted modern kitchen adjacent and white bathroom suite with electric shower. The property further benefits from modern electric heaters, double glazed throughout and is situated in a block of just 3 flats with a share of the freehold and a communal garden.

Located on the corner of Broad Street and Hatchgate Close, this conveniently positioned property allows for easy access to Haywards Heath and the mainline station and is a short walk to Cuckfield Village High Street with its array of boutique shops and local public houses not to mention the nearby open spaces, ideal for dog walkers and joggers to enjoy.

Council Tax Band: B  
 Services:  
 ELECTRIC: Mains  
 HEATING: Electric  
 WATER: Mains

Local Authority:  
 Mid Sussex District Council  
 Oaklands  
 Oaklands Road  
 Haywards Heath  
 West Sussex  
 RH16 1SS  
 Tel. 01444 458166  
 Fax. 01444 477236

## Energy Efficiency Graph

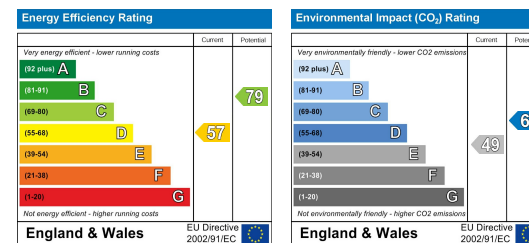

These particulars, whilst believed to be accurate are set out as a general outline only for guidance and do not constitute any part of an offer or contract. Intending purchasers should not rely on them as statements of representation of fact, but must satisfy themselves by inspection or otherwise as to their accuracy. No person in this firm's employment has the authority to make or give any representation or warranty in respect of the property.